



DEPARTMENT OF ENGINEERING AND PLANNING  
 Division of Engineering  
 One Spring Street  
 Newton, New Jersey 07860  
 973-579-0430  
[dpw@sussex.nj.us](mailto:dpw@sussex.nj.us)  
 Matthew R. Sinke, P.E.  
 Division Director/Assistant County Engineer

**Construction Notice – CR 620 (98 Main St.) Sparta Twp. Distributed: Mar. 14, 2019**

**Project:**

**Repair of Existing Drainage System at CR 620, MM 0.88, 98 Main Street, Sparta Township**  
 Block 27006, Lot 33, Sparta Township

**Construction Forces:**

- Sussex County Division of Public Works

**Advisory:**

The existing drainage system, which is located in a drainage easement at the project site, is damaged and/or clogged. The drainage system will be repaired and replaced, in-kind, to restore system operation.

**Anticipated Schedule:**

The Anticipated Schedule is as Follows:

- Start of site clearing – **On or about March 18, 2019**
- Additional Construction activities will follow site clearing as weather and staffing availability permits and is anticipated to last approximately 2-4 weeks.
- Tentative schedule is subject to change based on weather conditions and unforeseen circumstances.

**Construction Activities:**

Construction Work is as follows:

- Clear vegetation over the existing drainage system
- Install soil and erosion control measures
- Remove and replace/repair existing drainage system
- Site restoration

**CR 620 Traffic Impacts:**

- Single lane, flagger controlled work zones may be used along CR 620 (Main St.) during construction, as required during work hours, to facilitate the drainage system repair work.

**Contact Information:**

For more information about this project please feel free to contact Josh Roe, Engineer Trainee, of the Sussex County Division of Engineering at 973-579-0430 or [dpw@sussex.nj.us](mailto:dpw@sussex.nj.us)



CR 620/98 Main St. : View of Project Site Looking West



CR 620/98 Main St. : View of Project Site Looking East



Typical Drainage Pipe Installation



DEPARTMENT OF ENGINEERING AND PLANNING  
 Division of Engineering  
 One Spring Street  
 Newton, New Jersey 07860  
 973-579-0430  
[dpw@sussex.nj.us](mailto:dpw@sussex.nj.us)  
 Matthew R. Sinke, P.E.  
 Division Director/Assistant County Engineer

**Construction Notice – CR 620 (98 Main St.) Sparta Twp. Distributed: Mar. 14, 2019**

**CR 620/98 Main Street Drainage System: Location Map**

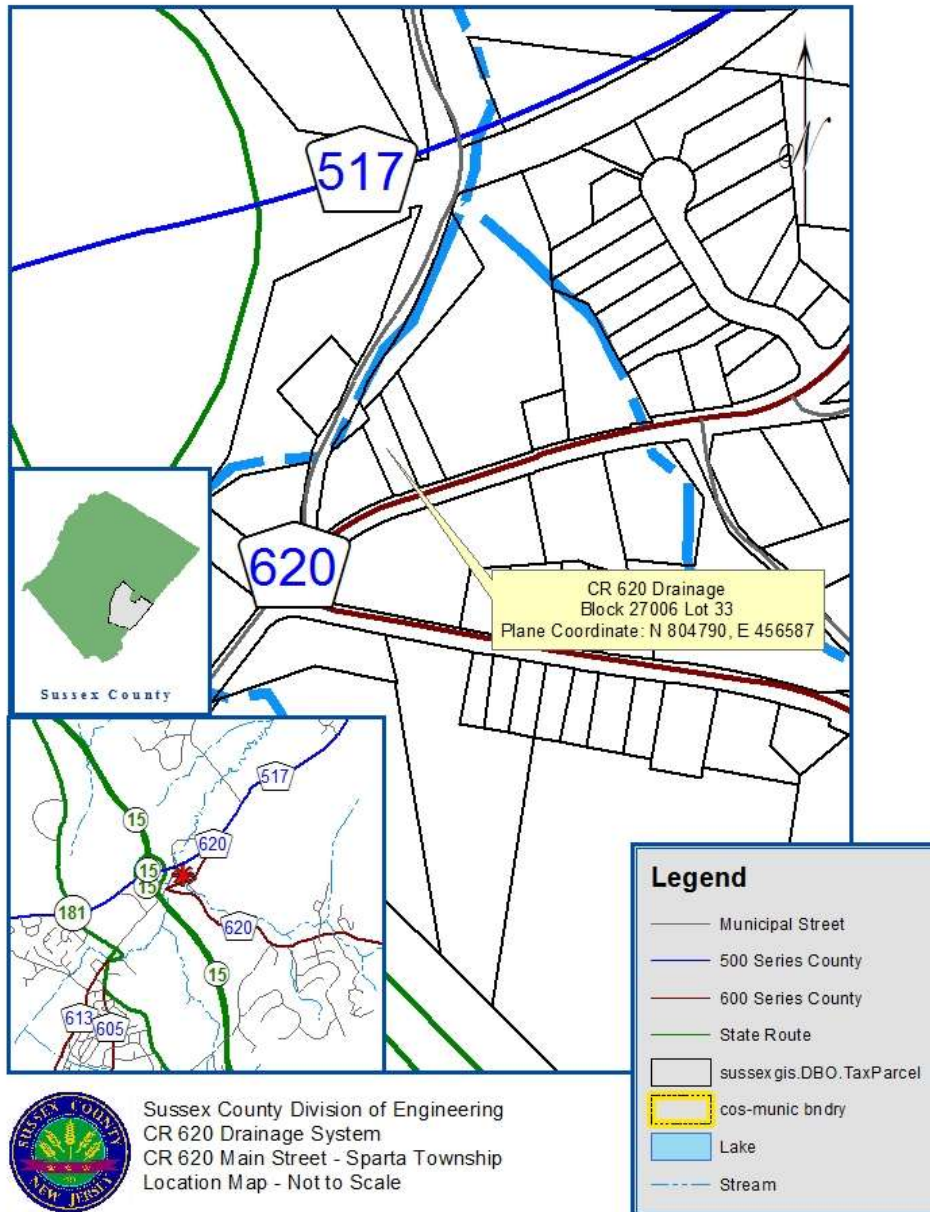

Sussex County Division of Engineering  
 CR 620 Drainage System  
 CR 620 Main Street - Sparta Township  
 Location Map - Not to Scale